



**SKROSS**<sup>®</sup>  
ADAPT TO THE WORLD

## Combo World to Israel

WorldConnect AG, Werkstrasse 12a,  
9444 Diepoldsau, Switzerland

WorldConnect AG, Bundesstrasse 112,  
6923 Lauterach, Austria

SKROSS.COM

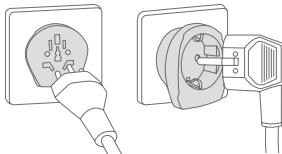
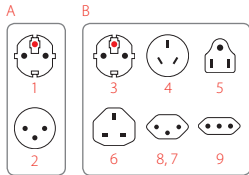
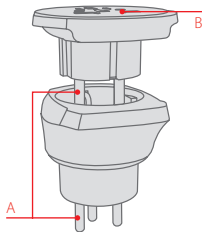

Adapter: maximum 16 A;  
100 V / 1600 W to 250 V / 4000 W

For the following devices:



Countrylist:



WEEE



## PRODUCT OVERVIEW & FUNCTIONS

Country Travel Adapter Combo World to Israel

FOR TRAVELLERS FROM: over 220 destinations worldwide

IN: Europe (Schuko) and Israel

A Compatibility – output

1 Europe (Schuko)

2 Israel

B Compatibility – input

3 Europe (Schuko & Euro)

4 Australia/China

5 USA/Japan

6 UK

7 Switzerland, 8 Brazil, 9 Italy

The Combo World to Israel is suitable for most 2-pole and 3-pole (earthed) devices in protection classes I and II.

## SAFETY PRECAUTIONS

- Keep the adapter out of the reach of children.
- The adapter is not a voltage converter.
- The input voltage for the device to be connected must match the voltage of the local mains power supply.

- The adapter is only intended for short-term use and should be disconnected from the mains after use.
- Never use the adapter if the casing is damaged.
- Never expose the adapter to liquids or moisture.
- Improper use of the adapter will invalidate the manufacturer's warranty. No liability is accepted for damages.

## CUSTOMER SERVICE

If you have any problems using SKROSS® adapters, please contact us on [support@skross.com](mailto:support@skross.com).

## WARRANTY TERMS

Two-year warranty. The full warranty terms can be found at [www.skross.com](http://www.skross.com).

All products and software mentioned in this document are registered brands belonging to the relevant brand owner. Subject to errors.

© 2019 WorldConnect AG. All rights reserved. SKROSS® is a registered trademark of WorldConnect AG. All trademarks and registered trademarks are the property of their respective owners. Subject to changes in technical specifications.

## WARRANTY & LIMITATION OF LIABILITY

This product has been designed and manufactured to meet international safety standards. Users must handle the product with due care and diligence. Product warranty is 24 months as of date of purchase strictly limited to replacement of deficient product. Other than for replacement of a deficient product during the warranty period, WorldConnect AG shall under no circumstances be liable for any direct, indirect and/or consequential loss and damage caused by (i) a deficient product; (ii) force majeure events; (iii) misuse of the product beyond its intended purpose (iv) usage contrary to the instructions set out in the product manual. Any liability is excluded for loss of profits, interruption of business, loss of data as well as any other loss and/or damages whether caused during proper operation or misuse of the product.